

Hilly Fields Crescent

Aims: to maintain existing character, open park with Planes (or investigate long term new tree planting with native forest species). Reinforce boundary and create wildlife links through gentle mounding and meadow planting.

Montague Avenue

Aims: maintain selected views. Long term infill and replanting fallen trees with parkland trees and edible fruits and nut trees, manage grass as spring meadow.

Montague Avenue Boundary

Aims: maintain views through into park. Selective tree planting to reinforce character of parkland

Manage willows

for regeneration insitu. Continue to facilitate dens building with cut willow and logs.

Meadow work with nature's gym and council to improve meadow habitat.

Adelaide Road

Aims: to maintain existing character, parkland meadow with lime trees to boundary

PLAY: build on integrating natural play into wider park and planting boundaries of playground, to enhance wildlife. Assess sites for basket swing and tree swing.

Retain fallen timber from park for play, den building and creative uses. Timber as fallen logs and log circles used for creating new seating.

HILLY FIELDS PARK DRAFT DEVELOPMENT PLAN

Principles agreed by Friends of Hilly Fields 2006

Rev D July, 2015

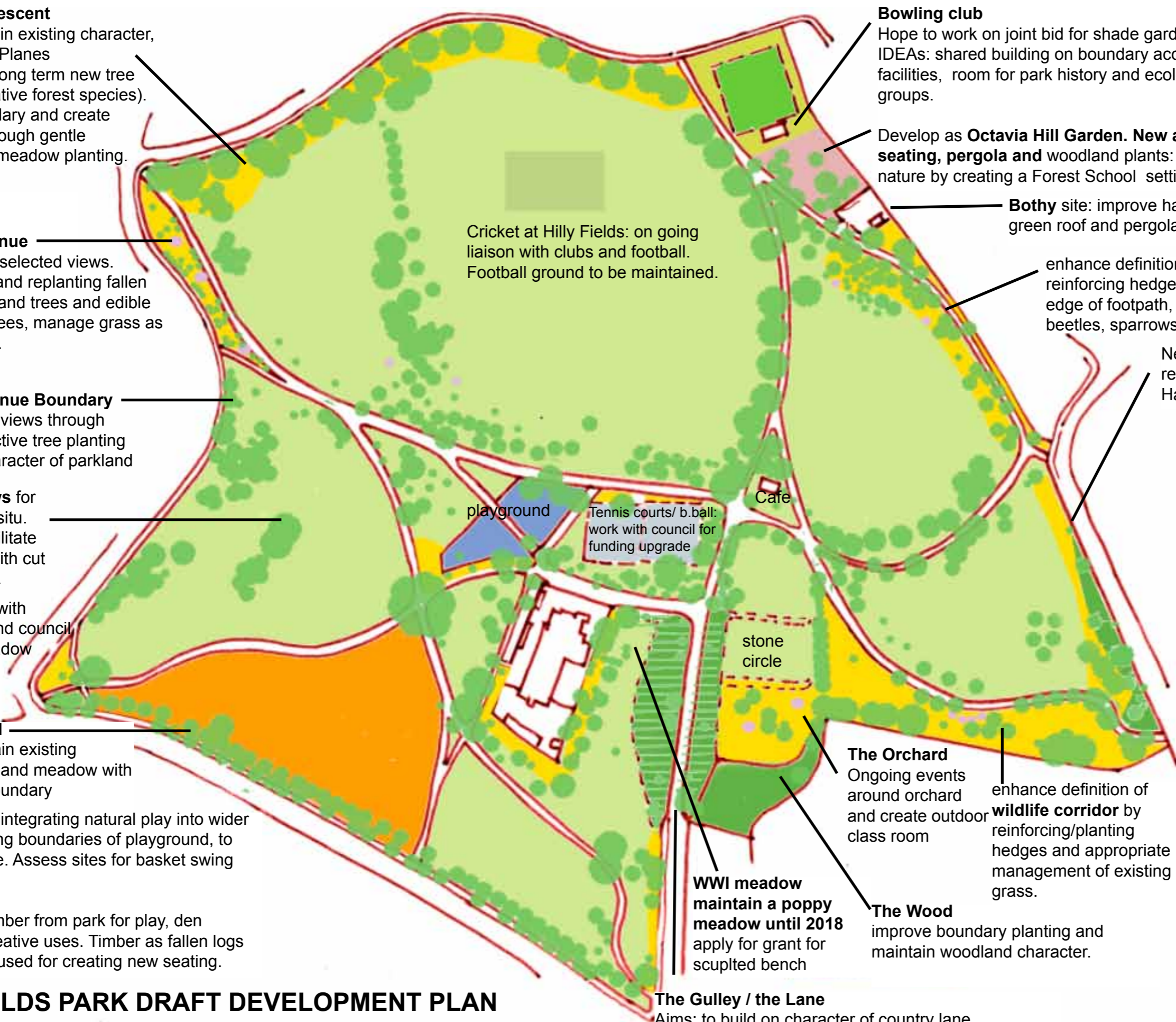

Cricket at Hilly Fields: on going liaison with clubs and football. Football ground to be maintained.

playground

Tennis courts/ b.ball: work with council for funding upgrade

Cafe

stone circle

WWI meadow maintain a poppy meadow until 2018 apply for grant for sculpted bench

The Gully / the Lane
Aims: to build on character of country lane. Granite sett crossover at gate and tar spray and chip road surface to reinforce that it isn't a public road.

Bowling club

Hope to work on joint bid for shade garden and bowls club. IDEAs: shared building on boundary access from both sides, with bowls club facilities, room for park history and ecology display, storage for education groups.

Develop as **Octavia Hill Garden**. New access gates and linking path, new seating, pergola and woodland plants: to link Octavia's passion for access to nature by creating a Forest School setting and enhancing ecology.

Bothy site: improve habitat and aesthetic green roof and pergola to screen portacabin.

enhance definition of **wildlife corridor** by reinforcing hedges and new hedgerow plants to edge of footpath, specifically create habitats for stag beetles, sparrows and bats.

New railing options to be discussed retain character of planting with Hawthorns trees.

GENERAL ISSUES

PATHS:major repair and resurfacing as many in poor state and inaccessible for wheelchairs.

TREES: to be developed in tree strategy. Need to ensure historic views not obscured by random tree planting. Species to be sympathetic to character of Victorian park, hilltop site and Lewisham biodiversity strategy. Strengthen planting bands with new fruiting trees. Promote (unmarked) memorial tree planting as legacy.

SIGNAGE: bespoke laser cut design for new entrance signs

FURNITURE: develop design in keeping with character of park

MAINTENANCE: improved general level of ongoing maintenance, tree work and grass cutting.

EVENTS: continue to organise activities to raise awareness of the park, its wildlife and history etc.

Continue liaison with wildlife groups and monitoring/surveying programmes.

The Orchard

Ongoing events around orchard and create outdoor class room

enhance definition of **wildlife corridor** by reinforcing/planting hedges and appropriate management of existing grass.

The Wood

improve boundary planting and maintain woodland character.